



Saint Mary Sanctuary of Monte Varese

SANTUARIO DI SANTA MARIA DEL MONTE

Via Assunzione, 21 • 21030 Santa Maria del Monte (VA) Italia

Tel. 0332 229223 • Sito: www.sacromontedivarese.it

e-mail: sacromonte@chiesadimilano.it

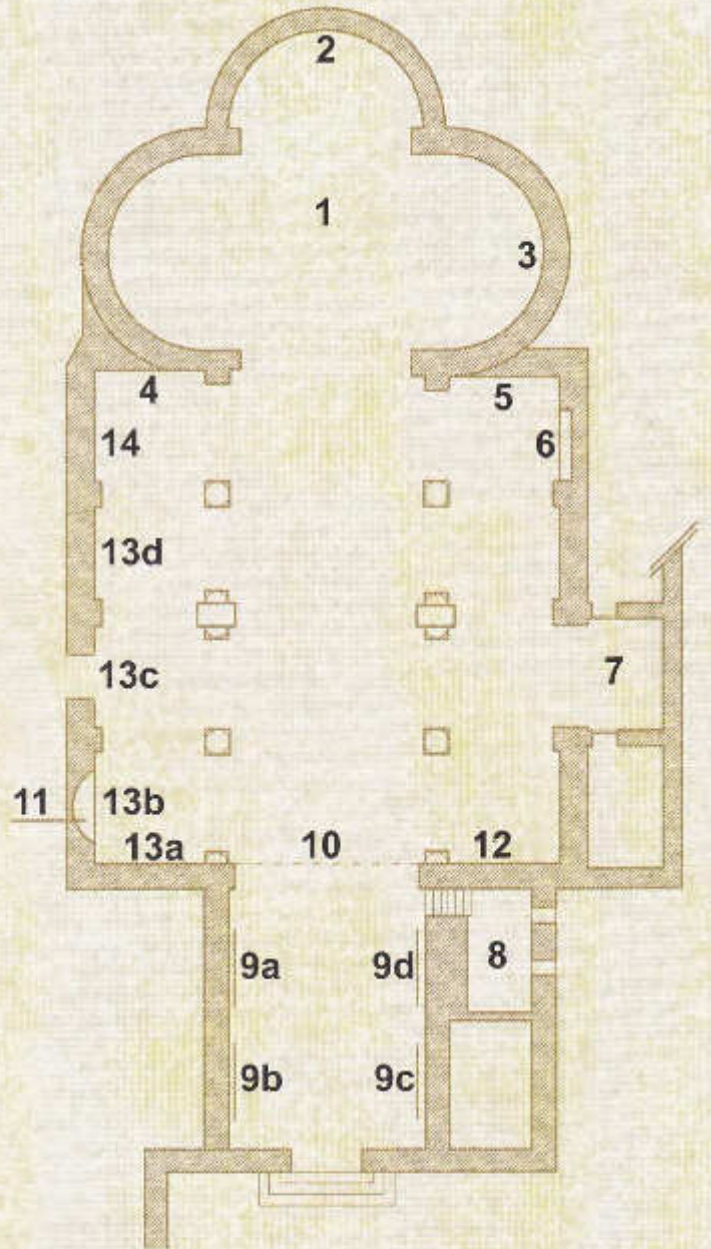

MASS

IN WINTER FROM 1st OCTOBER TO 30th APRIL
HOLIDAYS 7.30 - 9 - 11 - 16.30 • WEEKDAYS 8 - 16.45

IN SUMMER FROM 1st MAY TO 30th SEPTEMBER
HOLIDAYS 7.30 - 9 - 11 - 16.30 - 17.45 • WEEKDAYS 8 - 16.45

CHIESA DELL'IMMACOLATA (FIRST CHAPEL)

HOLIDAYS 8.30 • SATURDAYS AND DAYS BEFORE HOLIDAYS 18



1 - Baroque marble ALTAR (1660-1690) by G. Rusnati, with painting of the Madonna del Monte on wood (14th century). ANTEPENDIUM of gilded and silvered bronze, by Ludovico Pogliaghi (1945) with representations of St. Ambrose, St. Charles and St. Augustine.



2

2 - ORGAN - the original dated 1531 was built in the organ workshop of Antegnati in Brescia. It was originally placed on the landing below the grilled window in the front of the central nave and was transferred to the apse in 1578. Rebuilt by Biroldi in the 19th century after a fire.



3

3 - VIRGIN WITH CHILD late 15th century (epoch of Ludovico II Moro). The fresco is remains of a larger painting from the Sforzesco era.



4

4 - ALTAR - PRESENTATION OF CHRIST IN THE TEMPLE or CIRCUMCISION (circa 1580)
- Perspective view by Pellegrino Tibaldi
- the painted and gilded wooden statues are attributed to Andrea Prestinari.



5

5 - ALTAR - ADORATION OF THE MAGI (1510/1530?) painted and gilded wooden statues, artist unknown (possibly Andrea Da Milano).

6 - ANNUNCIATION - bronze by Enrico Manfrini (1983) erected on the spot where once the (empty) sarcophagus of St. Catherine stood.



6

7 - MARTIGNONI CHAPEL (1680) - built on request of Abbot Gerolamo Martignoni. The paintings are attributed to Stefano Maria Legnani, also called "Legnanino". Special attention should be paid to the altarpiece "Christ takes leave of his Blessed Mother" (oil on canvas, by Legnanino 1693) and "Supper at Emmaus" on the flap of the tabernacle (also by Legnanino).



7



8

8 - CHAPEL OF THE SAINTS (1669) The marble altar and altarpiece house the bodies of St. Catherine and St. Juliana, co-foundresses of the convent affiliated to the pilgrimage church, as well as many precious reliquary caskets. In the vault a painting by Antonio Busca (1686), "Glory of the Saints", the painted structures are attributed to the Grandi brothers.

9 – ST. AMBROSE'S VICTORY OVER THE ARIANS and DEDICATION OF MONTE DI VELATE TO THE BLESSED VIRGIN fresco in four parts by Salvatore Bianchi (1696)



a – St. Ambrose's siege of the tower on Monte Olona



d – Solemn dedication of the mountain to the Blessed Virgin



b – The Virgin's encouraging prophecy



c – Battle around the tower



10 – CHRIST BEARING THE CROSS, inviting Romite to follow him (the nun on the right hand of the painting as seen by the viewer, is Saint Catherine). The fresco is attributed to Bernardino Butinone (1480/1490).

12 – THE WEDDING FEAST AT CANA – fresco by Giovan Mauro della Rovere, also called "Fiammenghino" (1632)



13 – FRESCO LUNETTE PAINTING by Fiammenghino with scenes depicting the life of the blessed Virgin (1632)



a – The Birth of the Virgin



b – Presentation of Mary in the Temple



c – Wedding of the Virgin



d – Rest on the Flight into Egypt

11 – BAPTISTRY – of the original from 1699 remain parapet, gate and font. Restored in 1894 by Ludovico Pogliaghi, with decorations in white and blue polished plaster with grotesque motifs. Also interesting the reconditioned original Sforzesco pavement from the 15th century.





PRAYER TO OUR LADY OF THE SACRED MOUNT

Oh Mary, our dear Mother,
Virgin of the Sacred Mount!
City founded on the Mount of God
always illuminated by the sun of Christ
to guide the Way of Earth's pilgrims.

Oh merciful Queen! Turn your eyes
on your pilgrim children who ascend your Mount,
drawn by Your beauty! Show us the only begotten son of the
Father born of your womb.

Make us, oh Mother, the living stones
to build the magnificent City of God.
Oh Our Lady of the Sacred Mount!
We behold You as children who seek
their Mother's face, pilgrims tired
by the difficult ascent.

Beside You we relish the peace of heart.
Confirm us, oh Mother, in good will,
do not let us descend again,
give us the persevering commitment
to join You in heaven.
Amen.



14 - NATIVITY (MANGER) fresco by the Lampugnani brothers (1633) on the infill of a preexisting entrance door to the pilgrimage church.

